





# PILLAR<sup>AND</sup>POST

 122 guestrooms  
 11 meeting rooms

Maximize your meetings by turning business into productive pleasure. Your group will enjoy the comforts of Pillar and Post, with its warm country ambience and spacious, business-minded meeting rooms. The rich history of this former canning factory is balanced by its updated meeting rooms, complete with ample business amenities to satisfy the needs of today's corporate clients. Pillar and Post offers flexibility for a wide variety of groups and special events.

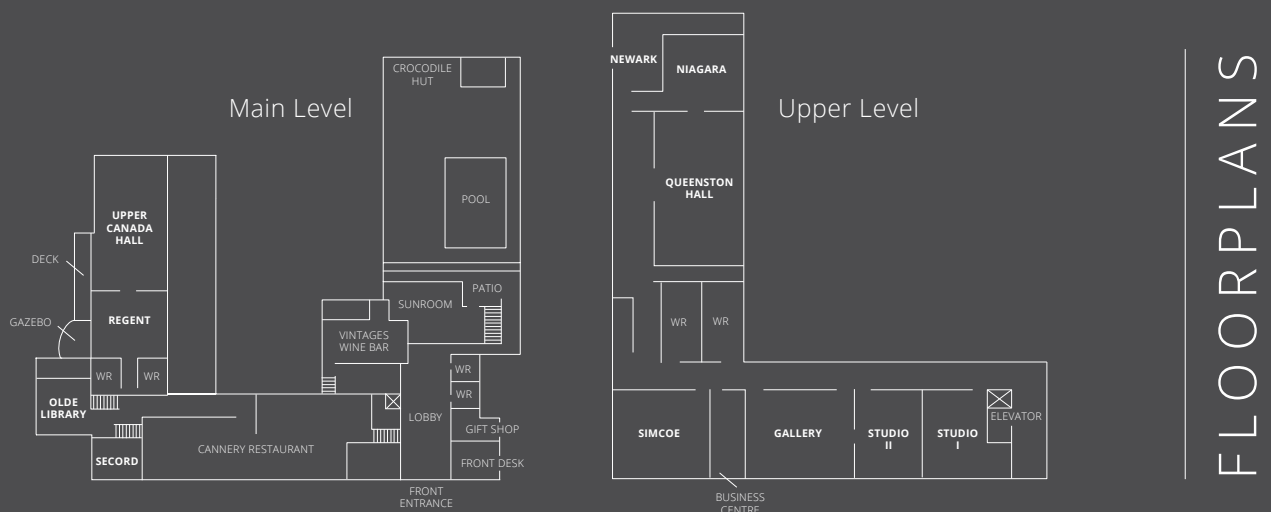

FLOORPLANS

## PILLAR & POST

### Main Level Conference Rooms

Meeting Room	Size	Area (sq. ft.)	Theatre	Classroom	U-Shape	Boardroom	Banquet	Hollow Square
Secord	24' x 20'	480	28	12	10	16	24	12
Olde Library	36' x 28'	1008	60	24	22	24	56	28
Regent	29' x 38'	1102	45	24	18	20	48	24
Upper Canada Hall	77' x 38'	2926	250	135	60	N/A	192/ 168 (with dancing)	70

### Upper Level Conference Rooms

Meeting Room	Size	Area (sq. ft.)	Theatre	Classroom	U-Shape	Boardroom	Banquet	Hollow Square
Studio I	21' x 28'	588	N/A	N/A	N/A	10	N/A	N/A
Studio II	23' x 28'	644	30	20	14	14	24	18
Newark	35' x 19'	665	N/A	N/A	N/A	16	N/A	N/A
Niagara	35' x 19'	665	40	20	20	16	32	24
Simcoe	36' x 28'	1008	60	36	26	20	56	32
Queenston Hall	46' x 26'	1196	90	42	34	28	80	38
Gallery	45' x 28'	1260	100	42	34	28	88	38

### Lower Level Conference Rooms

Meeting Room	Size	Area (sq. ft.)	Theatre	Classroom	U-Shape	Boardroom	Banquet	Hollow Square
Chicago Suite (Hospitality Suite)	20' x 40'	800	40	N/A	N/A	N/A	20	N/A

### BARN (EXTERIOR)

Meeting Room	Size	Area (sq. ft.)	Theatre	Classroom	U-Shape	Boardroom	Banquet	Hollow Square
Barn	39' x 35'	1365	70	40	30	28	77	N/A