

# MILLCROFT



Erin Room



Alton

## 52 Guestrooms • 6 Meeting Rooms

Solitude in a country retreat provides just the right environment for a brainstorming session or an intimate group event. Just 45 minutes from Toronto, The Millcroft delivers four-diamond accommodations and cuisine with Vintage style in a 100-acre woodland setting. Your group will relish the inherent charm of this unique historic property with its natural lighting and stone details. Superb business amenities enhance the group experience.

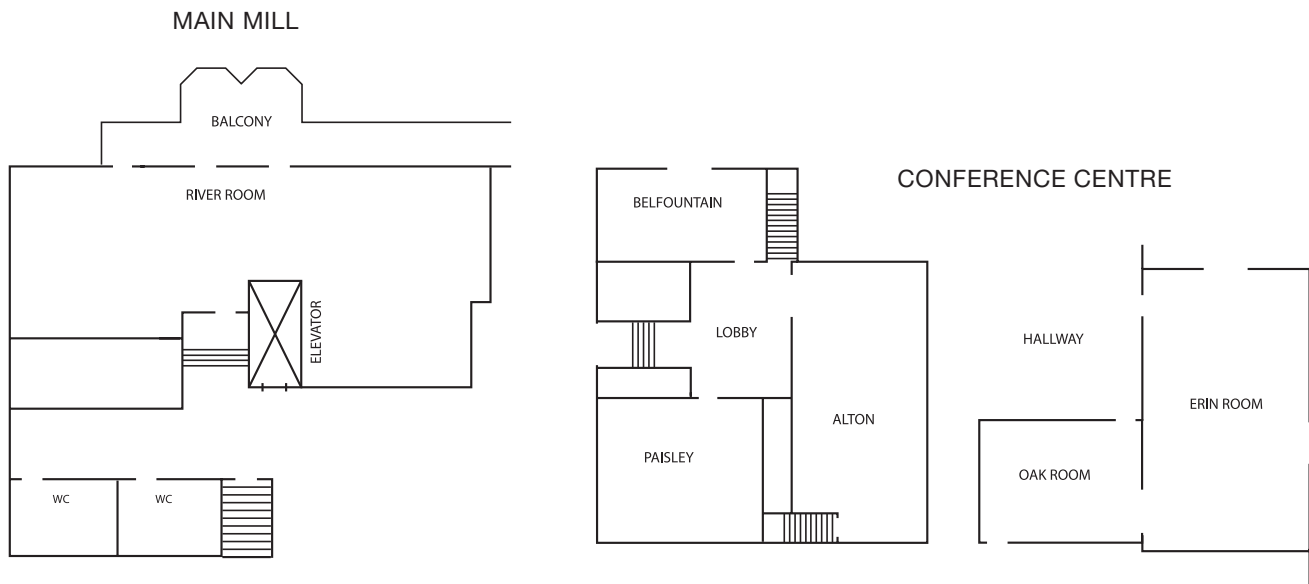

## MILLCROFT

### CONFERENCE ROOMS

Meeting Room	Size	Area (Sq. Ft.)	Theatre	Classroom	U-Shape	Boardroom	Banquet	Hollow Square
Erin Room	23' x 41.4'	952	80	55	34	28	60	42
Oak Room	20' x 14.5'	290	N/A	N/A	N/A	10	8	N/A
Alton	23' x 41.4'	952	80	40	34	26	54	42
Paisley	23' x 21'	483	30	18	18	16	24	20
Belfountain	23.7' x 13.9'	329	24	15	N/A	12	16	N/A
River Room	67.3' x 25.3'	1703	40	20	18	18	80	22

Contact one of our Sales Managers today to find out how to make your next meeting your best meeting

1-888-669-5566

[www.vintage-hotels.com](http://www.vintage-hotels.com)

[salesinquiry@vintage-hotels.com](mailto:salesinquiry@vintage-hotels.com)

55 John Street, Alton-Caledon, ON L7K 0C4 519-941-8111